

# Auger Weldment Assemble

## Part #P6006

for Models 6500

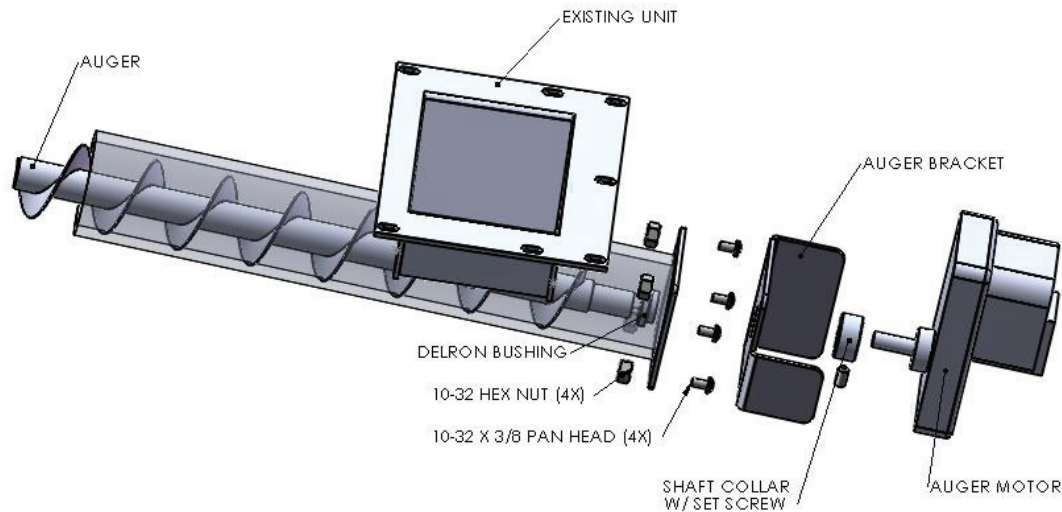

- Turn off power on control panel and unplug from the power supply.
- Remove all fuel from the hopper.
- Open both side panels.
- Loosen Allen screw on auger shaft collar w/ set screw.
- Pull off auger motor.
- Pull auger towards the front of the stove as shown make sure the white Delron bushing stays on the auger shaft.
- Place the white Delron bushing onto new shaft.
- Slide the auger into tube making sure the bushing is positioned correct will be approx. 1/8" of white delron bushing sticking through the auger bracket.
- Slide the shaft collar back on auger shaft, aligning the set screw to hole on the auger shaft.
- Slide on the auger motor by aligning the flat shaft on the auger to the Allen screw on shaft collar and then tighten the set screw on the collar.
- Reconnect auger motor electrical leads and make sure wires are secured properly in the right panel.
- Close side panel.
- Restart unit.